

new
runner



Blast Freezers – BASIC Version

The BASIC range of blast freezers are the ideal appliance for chefs, pastry and ice cream makers who need reliability and simplicity.

They are fitted with a simplified electronic control panel, intuitive and user-friendly, which allows chilling cycles to be set extremely rapidly.

Chilling or freezing cycle can be selected by time or according to a probe inserted in the core of the product.

There is the possibility to select the following programs:

- **Soft chilling:** positive "delicate" temperature reduction (+3°C);
- **Hard chilling:** positive "rapid" temperature reduction (+3°C in 90' minutes), during this phase it reaches -20°C air temperature;
- **Freezing:** deep freezing or freezing (-18°C in 240' minutes) during this phase it reaches -40°C air temperature.

A wide range of products, from small countertop freezers with capacity for three GN 2/3 trays to the spacious freezers with capacity for fifteen GN 1/1 or 40x60 cm trays.

TECHNICAL DATA:

External dimensions (WxDxH)	cm
Trays capacity (trays pitch mm 67)	nr
Yield *	
Max absorbed power **	W
Refrigerated power ***	W
Gas	
Defrosting system	
Working cycle: by time	
Working cycle: by probe	
Input voltage	
Climatic class	

BCB/05R	
External dimensions (WxDxH)	52x85x88
Trays capacity (trays pitch mm 67)	5 GN 1/1
Yield *	+90/+3°C=15Kg +90/-18°C=10K
Max absorbed power **	1000
Refrigerated power ***	780
Gas	R452A
Defrosting system	Automatic with pause
Working cycle: by time	yes
Working cycle: by probe	yes
Input voltage	1x230V – 50Hz
Climatic class	5

*With ambient temperature of +32°C – load of standard sample of 125 gr. according to DIN 8953/8954

Evap. -10°C cond. +45°C *ASHRAE (Evap. -23,3°C cond. +54,4°C)



Core probe





Detail of internal ventilation

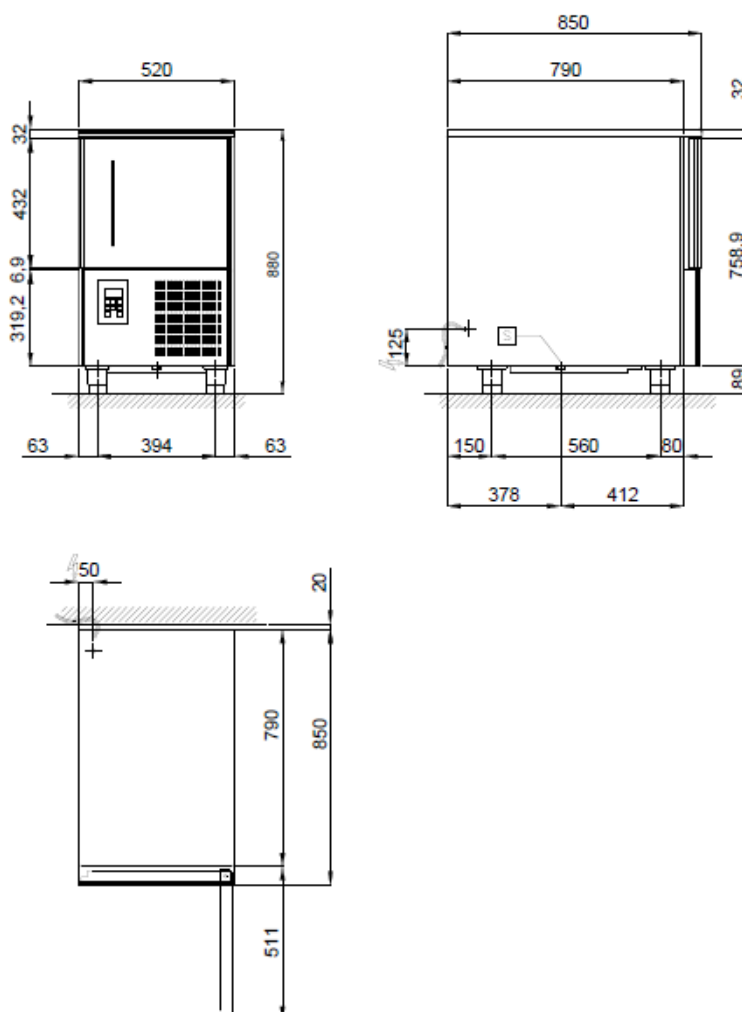

Control panel

INSTALLATION DIAGRAM:



 Electricity supply: 230 V ~ 1 – 50Hz (* SHUKO plug) – 2 mt wire length

 Condensate water drain pipe, L=1000mm

ACCESSORIES AND OVERPRICES ON REQUEST:

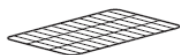

45100240 Stainless steel GN 1/1 rack



45000540 Set of castors Ø 100 mm



45020503 Water condensing unit for BCB

40200560 60Hz frequency (overprice)